



OSS - PC Type

ATS(800~6,300A)

Information to Order (주문정보)

OSS - 6□-□-□P-□-□
A B C D E

A Rated Current

08	10	12	16	20	25	32	40	50	63
800A	1000A	1250A	1600A	2000A	2500A	3200A	4000A	5000A	6300A

B Type

▶ PC : Standard

C Number of Poles

▶ 3 : 3P
▶ 4 : 4P

D Operating Voltage

▶ A1 : AC 110V
▶ A2 : AC 220V
▶ D1 : DC 110V
▶ D2 : DC 125V

E Mounting System

▶ F : Fixed
▶ D : Draw out

Features (특징)

■ One coil mechanism

One coil mechanism is applied.

■ Transfer indicator provided

Transfer indicator is fitted to indicate the transfer status.

■ Easier busbar arrangement

If the ATS is installed with the ACB in switchgear, Busbars can be easily arranged.

■ Fixed type & Drawout type available

Fixed type and Drawout type are available for customer's convenient applicaion.

■ Quick replacement of ATS

If malfunction occurs, drawout type of ATS can be changed within 5 minutes.

■ Perfect transfer mechanism

By spring transfer mechanism, ATS can be completely and perfectly transferred. There will be NO unattached position in any case.

■ Sufficient current capacity

Sufficient current carrying contacts are designed to withstand against over current.

■ Minimized opening & Closing impact

Opening and closing impact is minimized.

■ 1코일 절체 기구

정평이 있는 순시 여자 방식의 1코일 절체기구를 채택 했습니다.

■ 절체표시기 부착

절체의 상태를 확인할 수 있는 절체표시기를 부착하였습니다.

■ 부스바작업간편

ACB와 함께 배전반 설치시 부스바작업이 간편합니다.

■ 다양한 고객욕구를 만족

고정형과 인출형이 있어 다양한 고객욕구를 만족 시킬 수 있습니다.

■ ATS교체 시간 단축

인출형의 경우, 사고발생시 ATS 교체시간은 5분 이하입니다.

■ 불완전 투입요소 완전 제거

스프링 절체방식에 의해서 완전하고 완벽한 절체가 되도록 하였습니다. 양쪽 전원 중 어느 한쪽으로 반드시 접촉되도록 구조가 이루어 있습니다.

■ 과전류 방지

통전부의 독특한 점접구조에 의해서 과전류에 충분히 이겨 낼 수 있도록 설계되어 있습니다.

■ 개폐소크 미미

개폐조작시 개폐소크가 극소합니다.



OSS - PC Type

ATS(800~6,300A)

Specification (정격사양)

TYPE		608-PC		610-PC		612-PC		616-PC		620-PC	
Rated Voltage (정격 전압)	Ue	AC 600V, DC 125V									
Rated Current (정격 전류)	Ie	800A		1000A		1250A		1600A		2000A	
Neutral Phase Current (중성극전류)		800A		1000A		1250A		1600A		2000A	
Kind of Throw (투수)		Double Throw (쌍투)									
Connection (접속방식)		Back (배면)									
Number of Poles (극수)		3P	4P	3P	4P	3P	4P	3P	4P	3P	4P
Weight (중량)	Fixed (고정)	55kg	65kg	55kg	65kg	60kg	70kg	65kg	75kg	90kg	110kg
	Drawout (인출)	80kg	110kg	80kg	110kg	90kg	130kg	95kg	130kg	160kg	140kg
Rated Short-Time Withstand Current (1sec) (정격 단시간 전류)	Icw	25kA		25kA		30kA		35kA		40kA	
Short-Circuit Making Capacity (단락 Pick 전류)	Icm	52.5kA		52.5kA		63kA		73.5kA		84kA	
Switching Capacity (개폐 용량)		AC-33B (6 Ie making / 6 Ie breaking cos φ= 0.5) DC-31B (1.5 Ie making / 1.5 Ie breaking L/R=1ms)									
Switching Frequency (개폐 빈도)		60Time / Hour				20Time / Hour				10Time / Hour	
Operating Current (조작전류) rms/pick	DC 110V ~ 125V	45A				50A				65A	
	AC 100V ~ 110V	23A/45A				25A/50A				33A/65A	
	AC 200V ~ 240V	15A/30A				20A/40A				25A/50A	
Operating Time (동작시간)	Change - over time	≤ 120 ms								≤ 150 ms	
	Opening time	≤ 90 ms								≤ 120 ms	
Number of Operating Cycles (정격 개폐 회수)	Without Current	10,000								5,000	
	With Current	5,000								3,000	
Cautions (주의사항)		1. For complete operation, Be sure to provide control source for more than 0.5sec. 2. When control source will be provided to A side and B side simultaneously, Coil may be damaged. 1. 조작지령은 0.5sec이상으로 하여 확실한 동작을 할 수 있도록 하여 주십시오. 2. A측, B측 동시 조작지령시 코일 소손의 원인이 됩니다.									

TYPE		625-PC		632-PC		640-PC		650-PC		663-PC	
Rated Voltage (정격 전압)	Ue	AC 600V, DC 125V									
Rated Current (정격 전류)	Ie	2500A		3200A		4000A		5000A		6300A	
Neutral Phase Current (중성극전류)		2500A		3200A		4000A		5000A		6300A	
Kind of Throw (투수)		Double Throw (쌍투)									
Connection (접속방식)		Back (배면)									
Number of Poles (극수)		3P	4P	3P	4P	3P	4P	3P	4P	3P	4P
Weight (중량)	Fixed (고정)	90kg	110kg	100kg	120kg	180kg	220kg	185kg	230kg	200kg	250kg
	Drawout (인출)	160kg	140kg	125kg	155kg	220kg	275kg	310kg	305kg	310kg	305kg
Rated Short-Time Withstand Current (1sec) (정격 단시간 전류)	Icw	50kA		50kA		65kA		65kA		65kA	
Short-Circuit Making Capacity (단락 Pick 전류)	Icm	105kA		105kA		143kA		143kA		143kA	
Switching Capacity (개폐 용량)		AC-33B (6 Ie making / 6 Ie breaking cos φ= 0.5) DC-31B (1.5 Ie making / 1.5 Ie breaking L/R=1ms)									
Switching Frequency (개폐 빈도)		10Time / Hour									
Operating Current (조작전류) rms/pick	DC 110V ~ 125V	65A				80A					
	AC 100V ~ 110V	33A/65A				40A/80A					
	AC 200V ~ 240V	25A/50A				33A/65A					
Operating Time (동작시간)	Change - over time	≤ 150 ms									
	Opening time	≤ 120 ms									
Number of Operating Cycles (정격 개폐 회수)	Without Current	5,000				3,000					
	With Current	3,000				1,500					
Cautions (주의사항)		1. For complete operation, Be sure to provide control source for more than 0.5sec. 2. When control source will be provided to A side and B side simultaneously, Coil may be damaged. 1. 조작지령은 0.5sec이상으로 하여 확실한 동작을 할 수 있도록 하여 주십시오. 2. A측, B측 동시 조작지령시 코일 소손의 원인이 됩니다.									

OSS - PC Type

ATS(800~6,300A)



Outline Dimension (외형도)

800~1600A Fixed

unit : mm

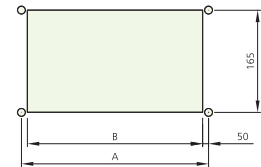
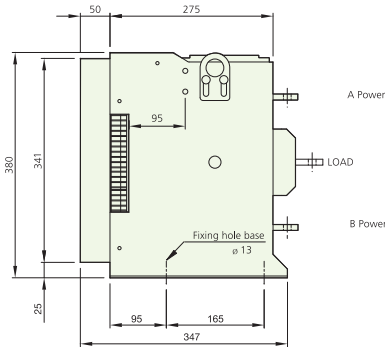
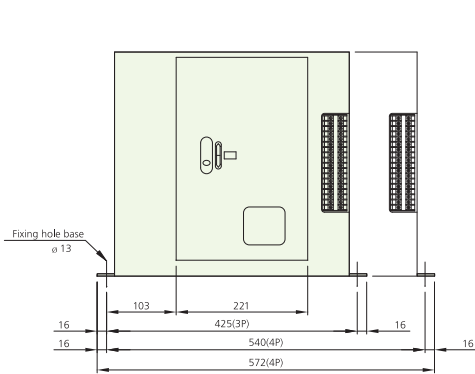

Poles	A	B
3P	425	325
4P	540	440

Panel cutting
(Fixing hole)

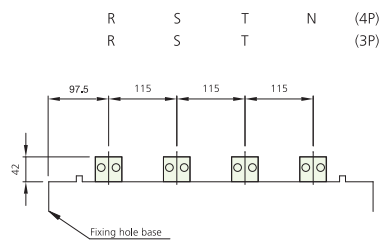
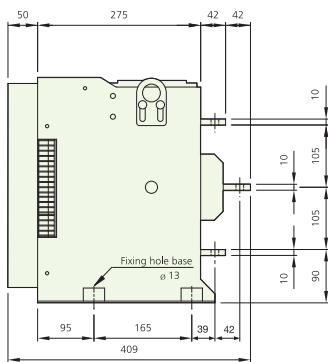

OSS-608~610-PC

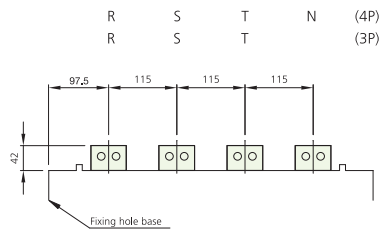
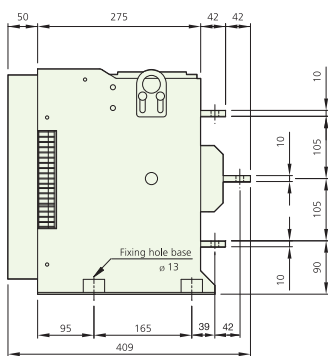
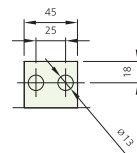

OSS-612-PC

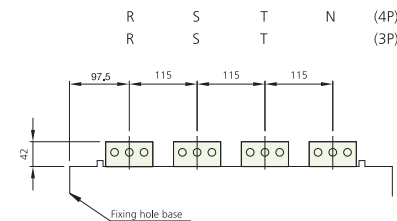
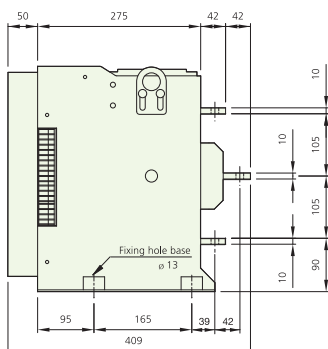
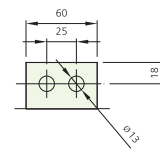

OSS-616-PC

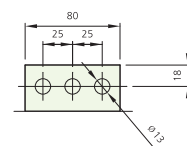



OSS - PC Type

ATS(800~6,300A)

Outline Dimension (외형도)

2000~3200A Fixed

unit : mm

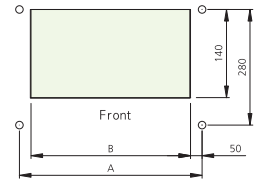
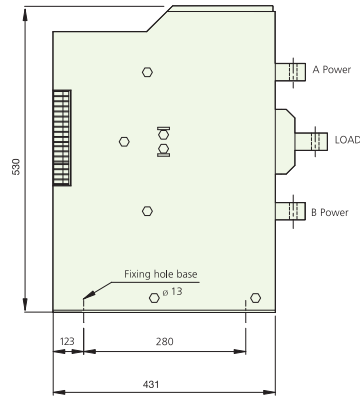
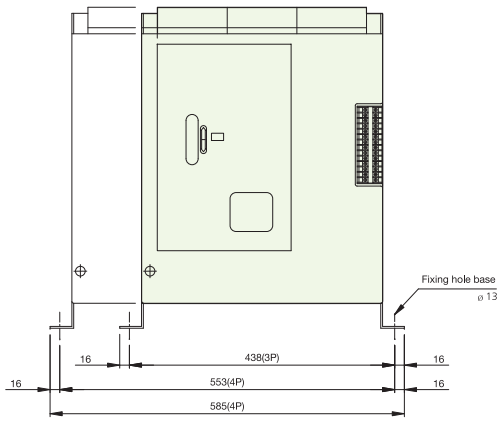

Poles	A	B
3P	438	338
4P	553	453

Panel cutting
(Fixing hole)

OSS-620~625-PC

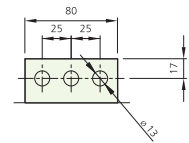
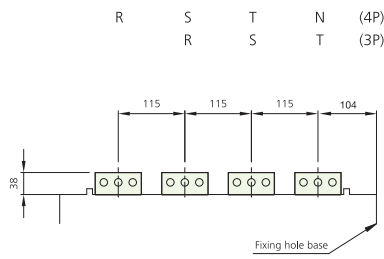
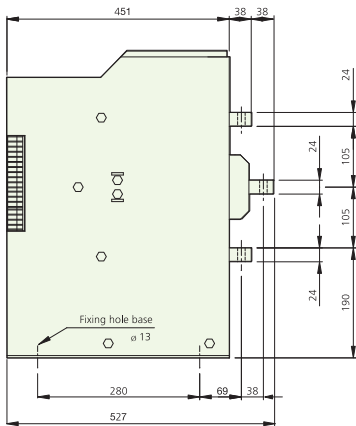

OSS-632-PC

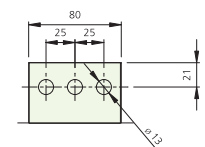
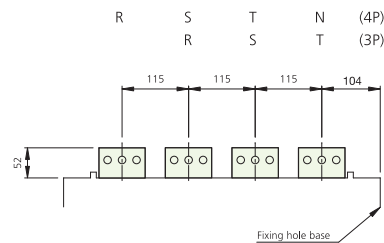
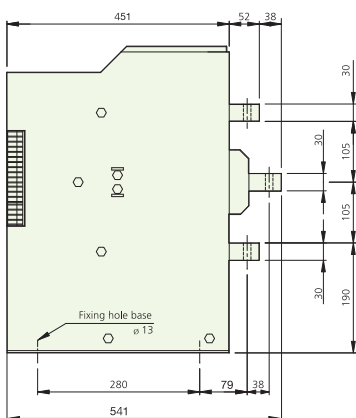



OSS - PC Type

ATS(800~6,300A)

Outline Dimension (외형도)

4000~6300A Fixed

unit : mm

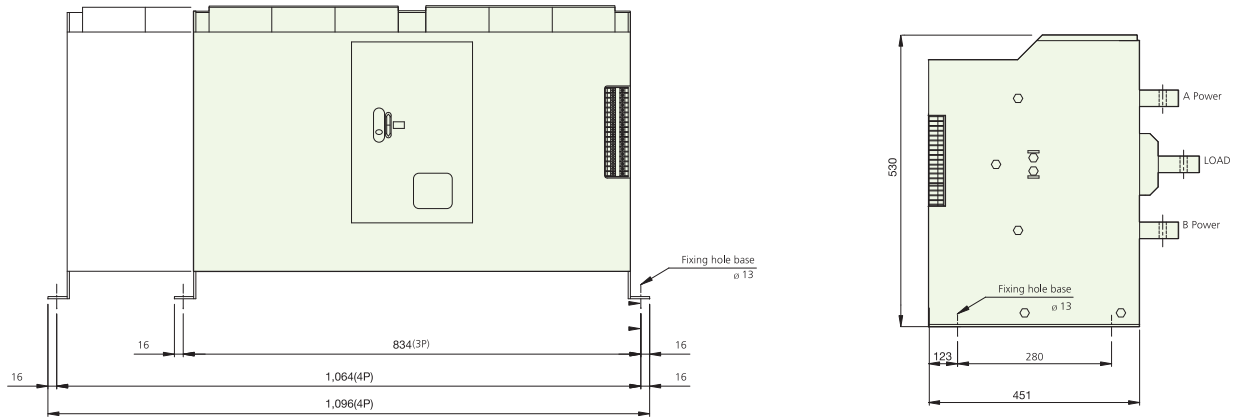

OSS-640-PC

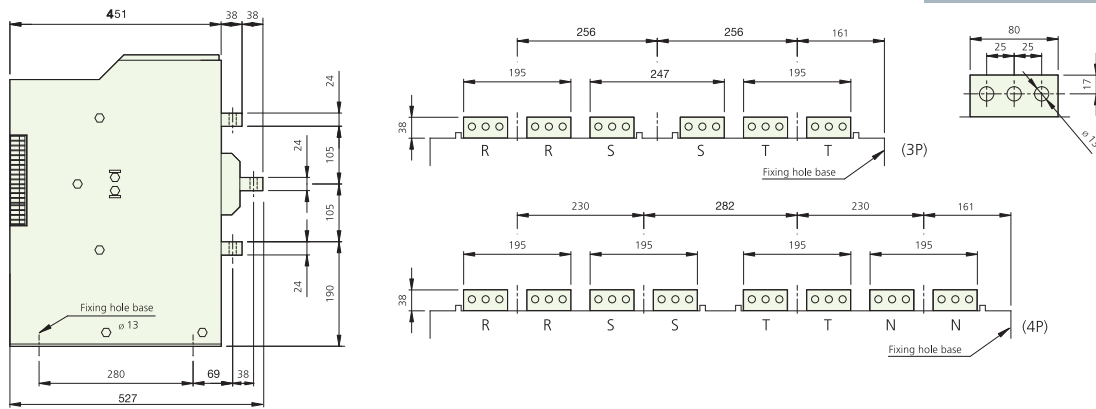

OSS-650~663-PC

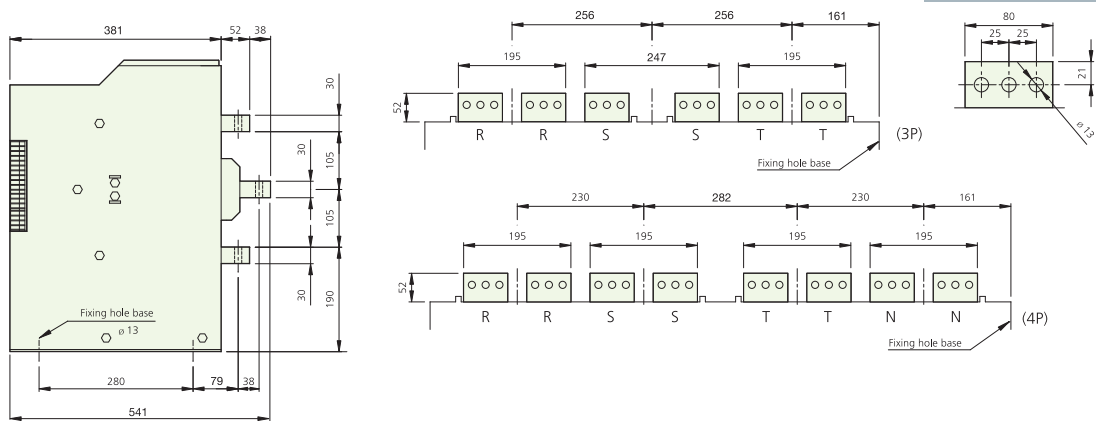

Panel cutting (Fixing hole)

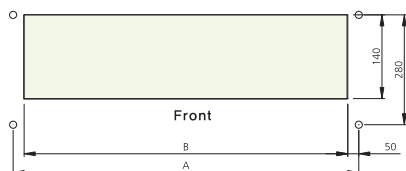

Poles	A	B
3P	834	734
4P	1064	964



OSS - PC Type

ATS(800~6,300A)

Outline Dimension (외형도)

800~1600A Draw Out

unit : mm

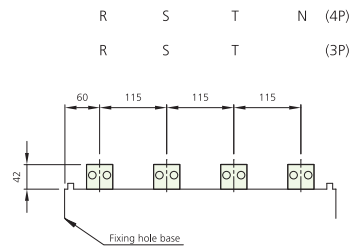
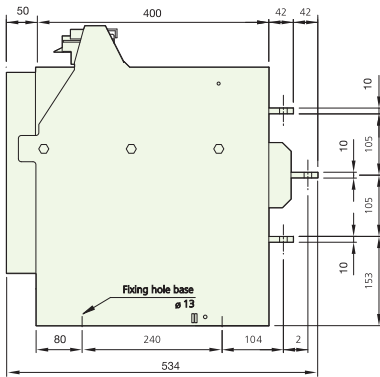
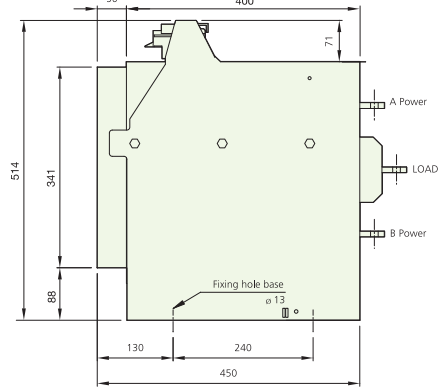
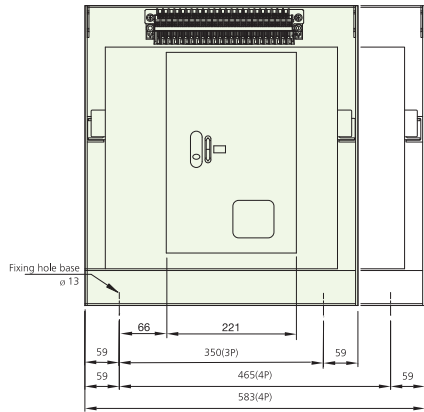

OSS-604~610-PC

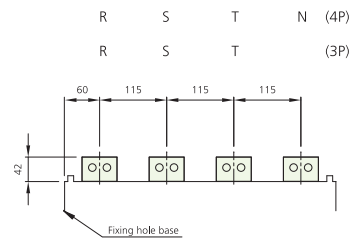
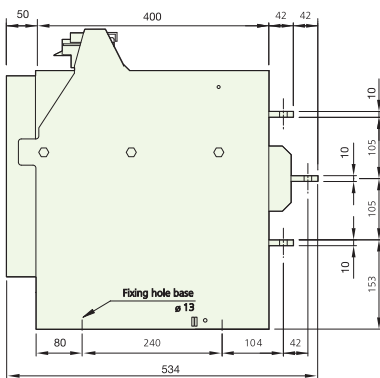
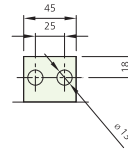

OSS-612-PC

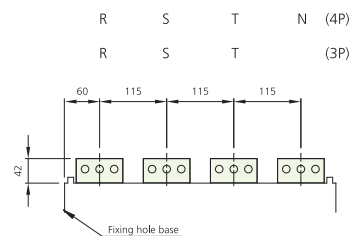
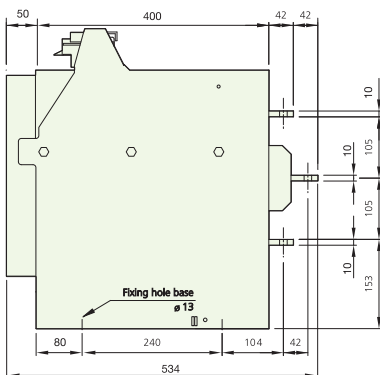
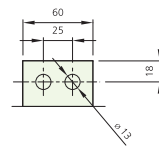

OSS-616-PC

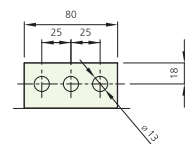



OSS - PC Type

ATS(800~6,300A)

Outline Dimension (외형도)

2000~3200A Draw Out

unit : mm

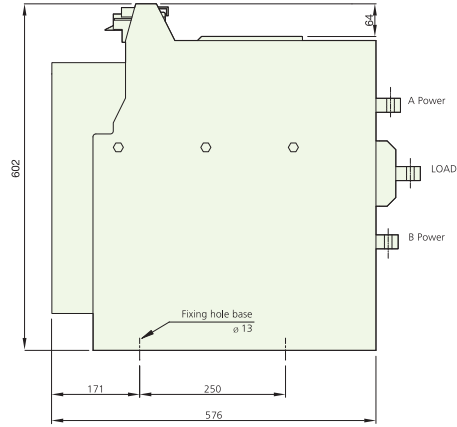
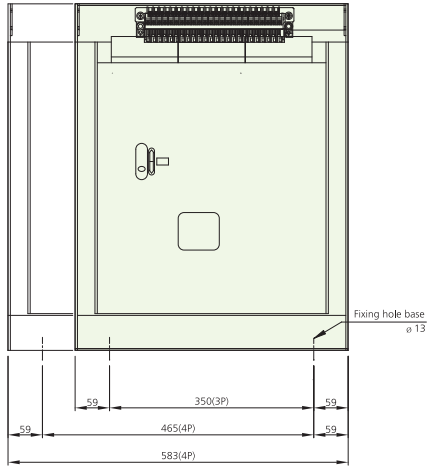

OSS-620~625-PC

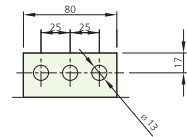
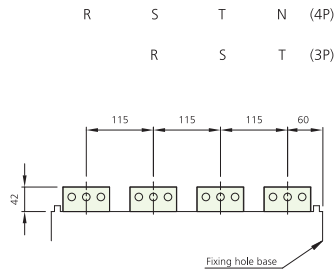
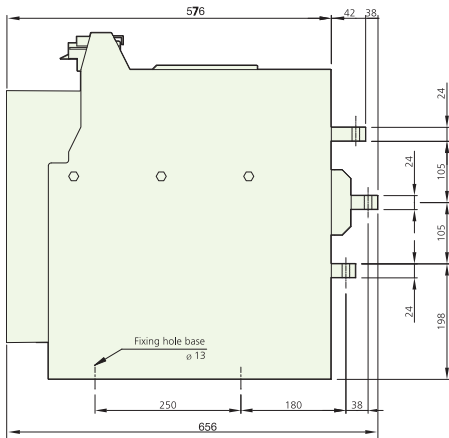

OSS-632-PC

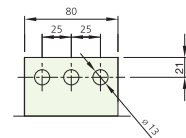
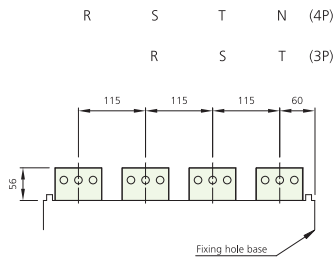
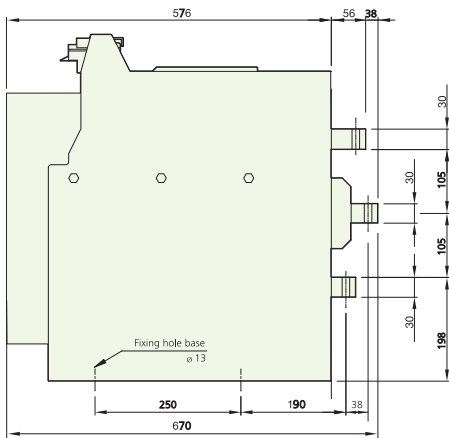



OSS - PC Type

ATS(800~6,300A)

Outline Dimension (외형도)

4000~6300A Draw Out

unit : mm

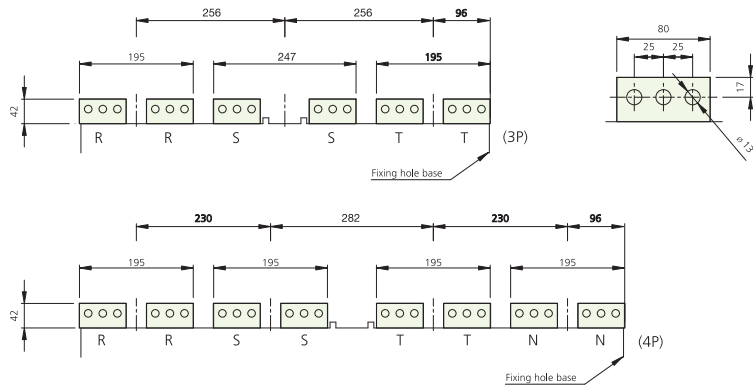
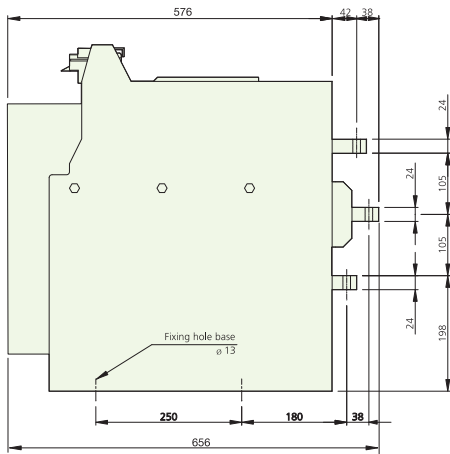
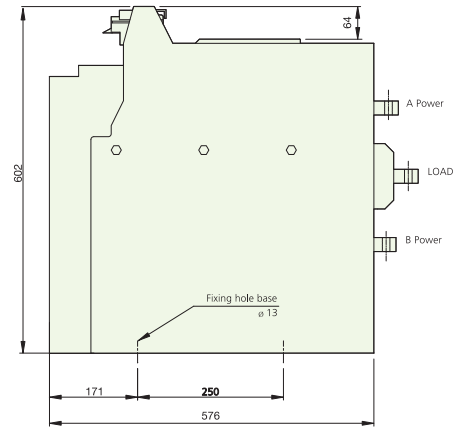
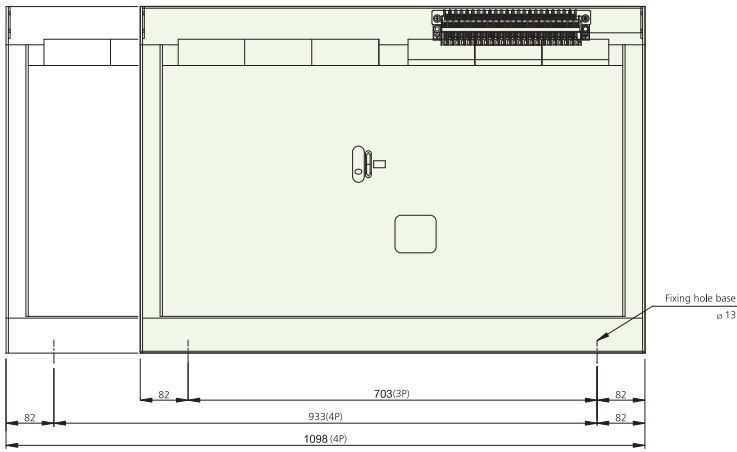

OSS-640-PC

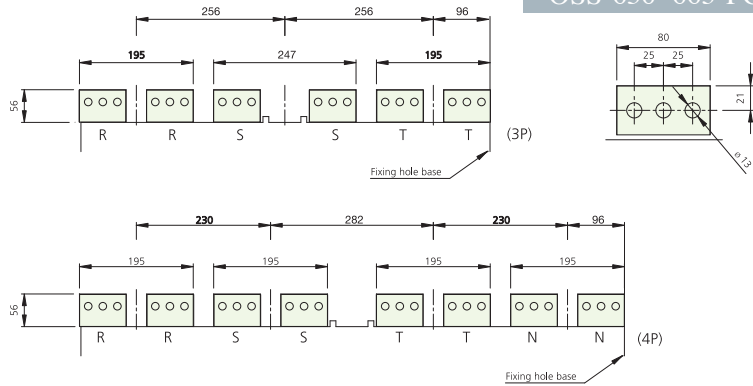
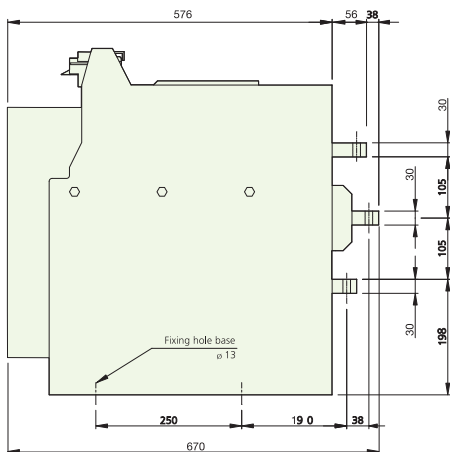

OSS-650~663-PC



OSS - PC Type

ATS(800~6,300A)

Wiring Diagram (결선도)

AC 110V, AC 220V

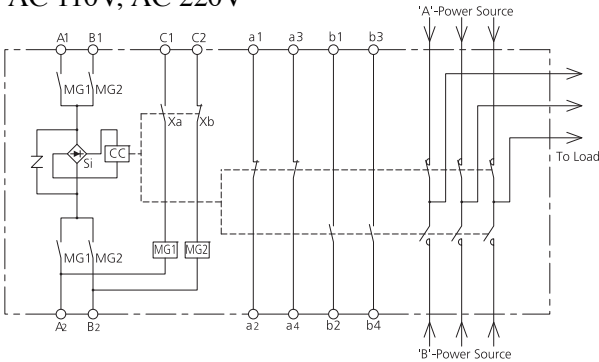

DC 110V, DC 125V

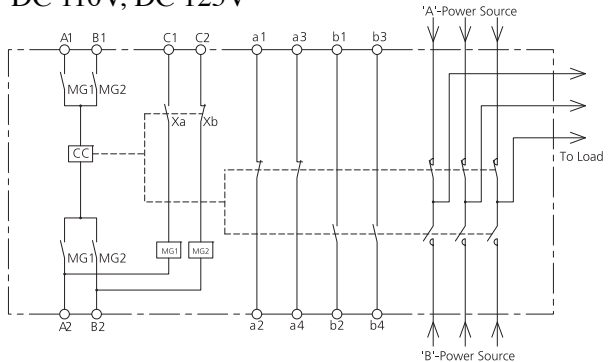

A1, A2	A-Power Closing Terminal	AX, BX	Control Switch
B1, B2	B-Power Closing Terminal	MG1, MG2	Magnetic Coil
CC	Closing Coil	a1, a2, a3, a4	A-Power Aux Switch
Si	Silicon Rectifier	b1, b2, b3, b4	B-Power Aux Switch

Typical Operating Circuit (대표적 조작회로 예)

Standard
(일반적인 절체)

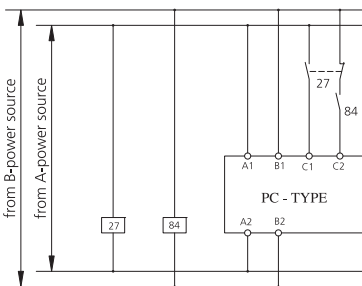

Using a changeover switch
(수동-자동 절체)

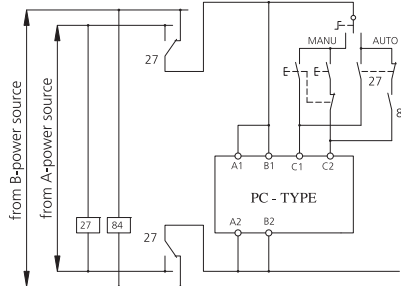

Using a timer
(타이머를 이용한 절체)

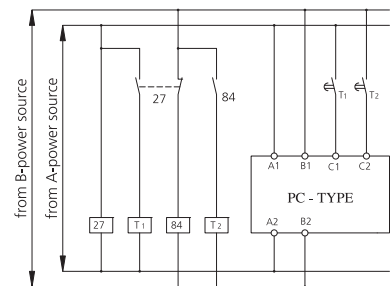

Wiring Diagram (결선도)

AC Operating and Control

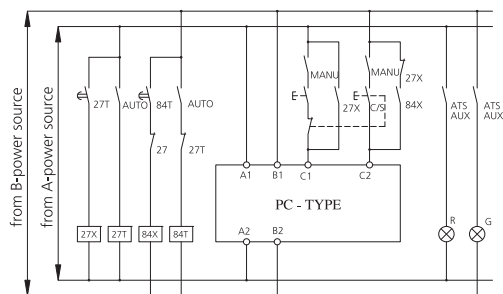

DC Operating and Control

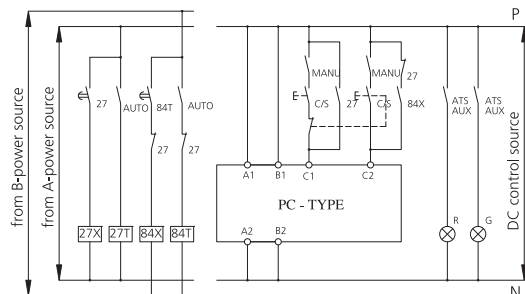

27X	Source-A Operating Relay	84X	Source-B Operating Relay
27T	27X Operating Delay Relay	84T	84X Operating Delay Relay
AUTO, MANU	Automatic, Manual	C/S	Control Switch

Caution : More than 2.5mm² power cable used for less than 1,600A ATS.
More than 4.0mm² power cable used for more than 2,000A ATS.